

**Physical Address:**

CRANE Instrumentation & Sampling
 405 Centura CT,
 Spartanburg, SC 29303-6603
 Phone: (864) 574-7966
 Fax: (864) 587-5608
 Email: [Click Here](#)

Mailing Address:

HOKE
 PO Box 4866,
 Spartanburg, SC 29305-4866

Item # CVH J 12 M 4 4 S, Male British Parallel Pipe, (Fractional)

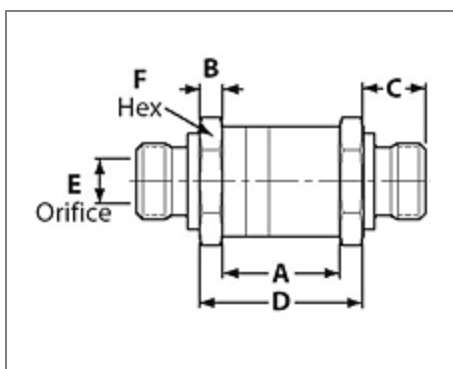

Specifications

Fitting Size	3/4"/12mm
Body Material	Monel R-405
Crack Pressure	10 psig (0.83 bar)
Seal Material	Kalrez
Cv Factor	7.38
Temperature	-40° to +400° °F -40° to +204° °C
A	2.05 in
B	.50 in
C	0.75 in
D	3.55 in
E	0.66 in

F

2.25 in

Features & Specifications

Rapid response
Resilient o-ring seat provides cushioned, noise-free closing and zero leakage
Floating o-ring design: o-ring is continually cleaned so contaminants do not prevent sealing
Various materials of construction can be used with any liquid or gas service
Various end connections can be assembled in any system or application
Spring-loaded poppet can be mounted in any orientation
Full flow with minimal restriction for maximum Cv rates
Virtually maintenance free for maximum dependability
Pressures up to 6000 psig (414 bar)
Cracking pressure range is 0.5 to 20 psig (0 to 1 bar) $\pm 10\%$
Flow up to 7.4 Cv maximum
Greater than 100,000 life cycles
Special High Tolerance NPT Thread