

**Physical Address:**

CRANE Instrumentation & Sampling  
 405 Centura CT,  
 Spartanburg, SC 29303-6603  
 Phone: (864) 574-7966  
 Fax: (864) 587-5608  
 Email: [Click Here](#)

**Mailing Address:**

HOKE  
 PO Box 4866,  
 Spartanburg, SC 29305-4866

## Item # HM832221Z10625, Double Block & Bleed Gauge Valves, Model-HM8322

Note: The body & trim parts on all 316/316L Valves & Manifolds comply to NACE MR-01-75 & NORSOK M-650 as standard.

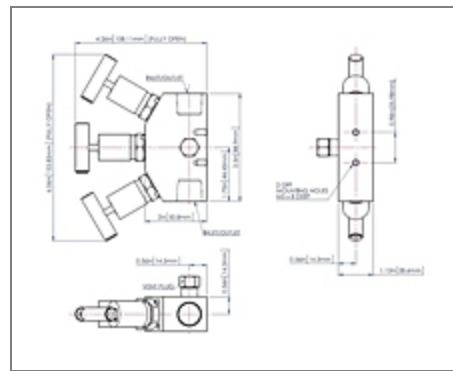

[Specifications](#) | [Application](#) | [Pressure Equipment Directive](#)

### Specifications

<b>Type</b>	Remote - Double Block & Bleed
<b>Fixed</b>	2
<b>Tip</b>	Soft
<b>Packing</b>	PTFE
<b>Inlet Connection</b>	Integral Metric
<b>Inlet Size</b>	10 mm
<b>Alloy</b>	625 INCONEL
<b>Weight</b>	2.87 lb 1.3 kg

<b>Maximum pressure at 212 °F (100 °C)</b>	6000 psi 413 bar
--	---------------------

<b>Maximum pressure at 392 °F (200 °C)</b>	4000 psi 275 bar
--	---------------------

## Application

High integrity instrument isolation of pressure gauges and pressure transmitters.

## Pressure Equipment Directive

Due to internal bore size and internal volumes up to and including 1"/25mm, products offered in this catalogue comply with S.E.P (Sound Engineering Practice) article 3, paragraph 3 of the Pressure Equipment Directive P.E.D. 97/23/EC and therefore CE marking is not applicable.